

## IRVING

*Purchased in 2013, QTS is transforming the former 700,000 square foot Maxim semiconductor manufacturing facility into a state-of-the-art data center. Strategically located on a 40-acre campus in the Irving/Las Colinas area, with the ability to double the footprint on the existing campus, QTS Irving is ideal for enterprise, medium and small organizations requiring significant room to grow.*



### BUILDING SPECIFICATIONS

- Purpose-built semi-conductor facility
- 54-acre campus
- 700,000 sq. ft. facility
- 292,000 sq. ft. total capacity raised floor
- Dedicated halls from 25,000 to 30,000 sq. ft.
- Column-free uninterrupted space; Halls 3, 4, 5 and 6
- Ability to double the footprint on the existing campus

### POWER

- Dual 138 kV feeds
- On-site Twin 70 MVA redundant substations (140 MVA total)
- Parallel redundant N+1 generator farm
- 104,000 gallons of on-site diesel fuel storage capable of powering for 48 hours; multiple refueling contracts
- 36MW of UPS power
- Flexible block redundant static UPS
- Able to meet N+1 or 2N distribution

### COOLING

- Air-cooled and water-cooled chillers
- 48 hours makeup water storage
- 150,000 gallon chilled water storage
- Water-side economization

### QUICK FACTS

- Designed to LEED standards
- Regional fiber connectivity provides two distinct and diverse paths out of the facility
- Security and technical staff on-site, 24 hours a day, every day
- 60 ft. concrete piers isolate the building from movement



## IRVING

### SECURITY

- 24x7x365 manned facility
- Manned guard gate
- Secured, single-vehicle entry only with card key
- 8 ft. Ameristar Impasse security fence
- 16 ft. concrete wall protects critical infrastructure
- Manned visitor and screening booth
- Card key and two-factor biometrics authentication

### CONNECTIVITY

- Carrier-neutral facility
- Diverse building entrances with two distinct, separate Meet-Me Rooms
- Convenient in-building access to multiple providers
- Diverse access and redundancy to all regional carrier hotels and long haul carrier POPs

### FIRE DETECTION AND PROTECTION

- A Very Early Smoke Detection System (“VESDA”) deployed throughout the facility provides primary fire monitoring
- Dual interlock pre-action systems

### FACILITY MONITORING AND MANAGEMENT

- 24x7x365 on-site technical and security professionals
- Proactive facilities monitoring
- On-site experienced, certified electrical engineers and skilled mechanical engineers
- Attentive, resourceful Data Center Operations

### BENEFITS

- Provides freedom, scalability and flexibility in design
- Carrier-neutral connectivity to multiple network providers
- Customizable power and space with exponential growth opportunity
- Leading internal and external security measures





# QTS IRVING MAP

6431 Longhorn Drive, Irving, TX 75063

1ST FLOOR

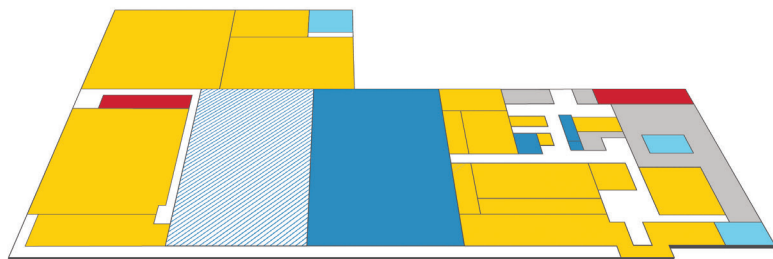

3RD FLOOR

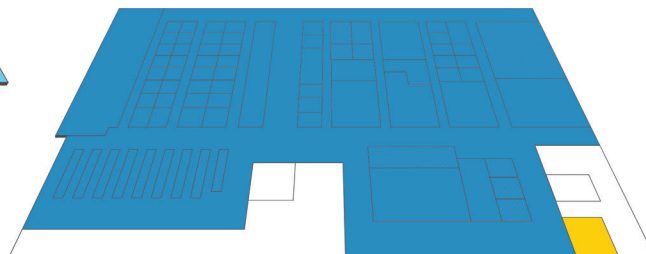

2ND FLOOR

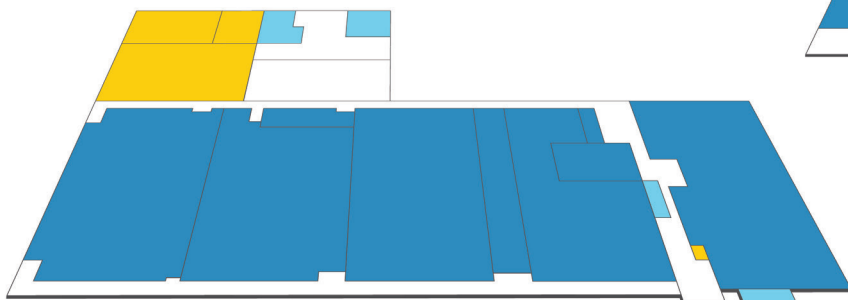

## PRODUCTS AND SERVICES

### CLOUD

- Enterprise Cloud
- DRaaS (Target Site)
- Private OpenStack Cloud
- Managed Cloud (EC)

### COLOCATION

### CONNECTIVITY

- crossConnect
- cloudConnect
- metroConnect
- data centerConnect
- ethernetConnect
- internetConnect
- Anti-DDoS

### MANAGED SERVICES

- Private Cloud/Dedicated Managed Hosting
- Monitoring Services
- Hardware Assure
- Managed Switch
- Managed Load Balancer
- Managed Firewall
- Managed Systems
- DB Services
- Backup Services
- Managed Storage - Dedicated
- Managed Storage - Shared
- Managed Security (Alert Logic)

### MTDC (MULTI-TENANT DATA CENTER)

- FUTURE DEVELOPMENT
- RAISED FLOOR
- MEET-ME-ROOM
- OFFICE SPACE
- MECH/ELEC
- LOBBY/SUPPORT